

Microsoft Class Teams for Students

1

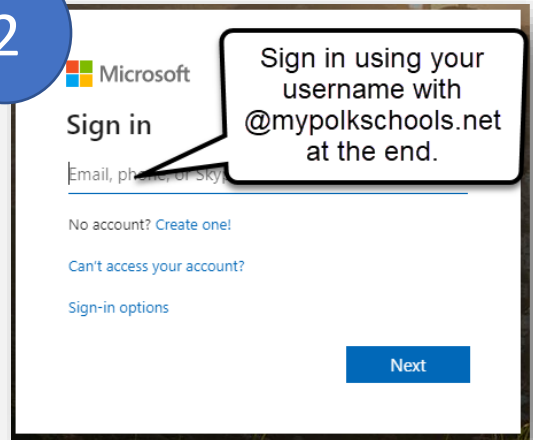

2



3

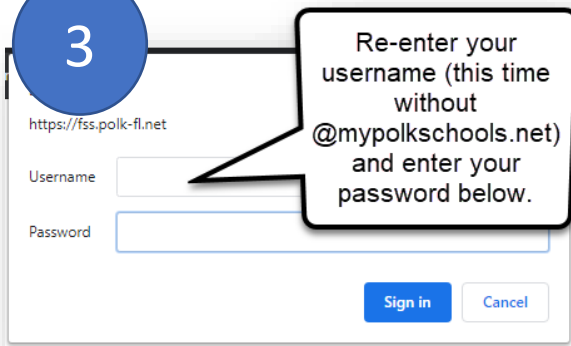

4

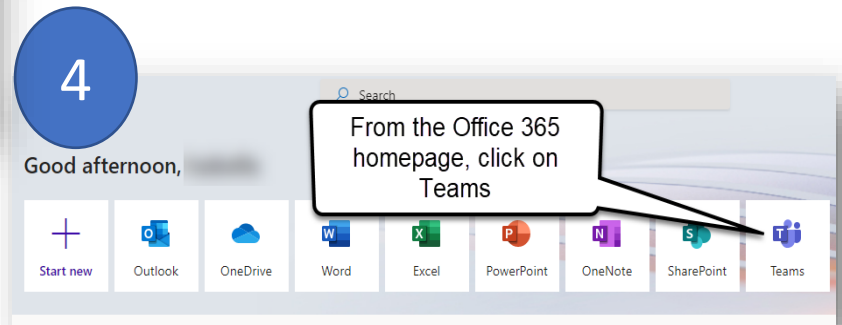

5

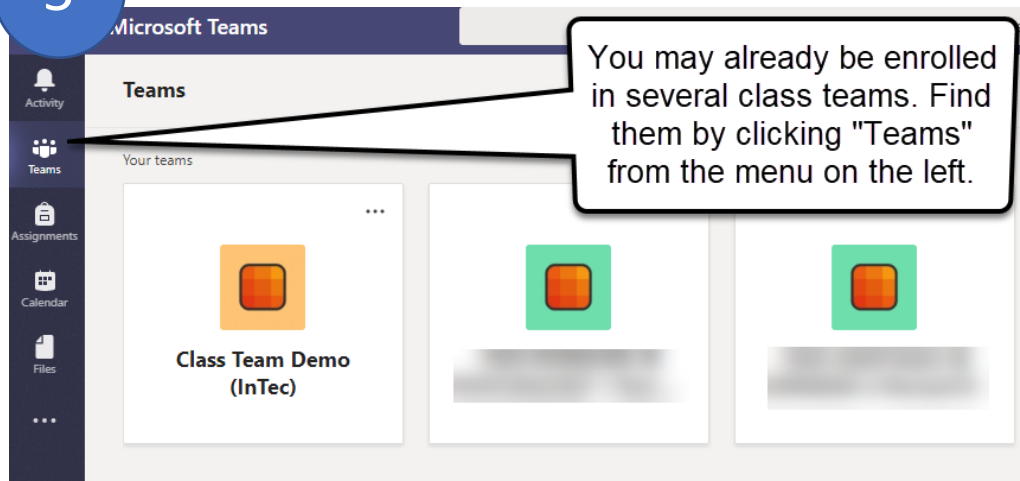

Google Classroom for Students

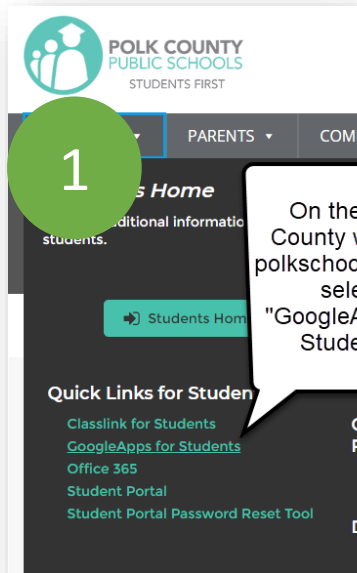

On the Polk County website polkschoolsfl.com, select "GoogleApps for Students"

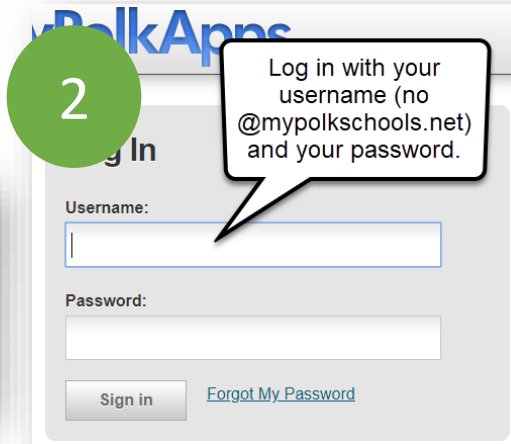

Log in with your username (no @mypolkschools.net) and your password.

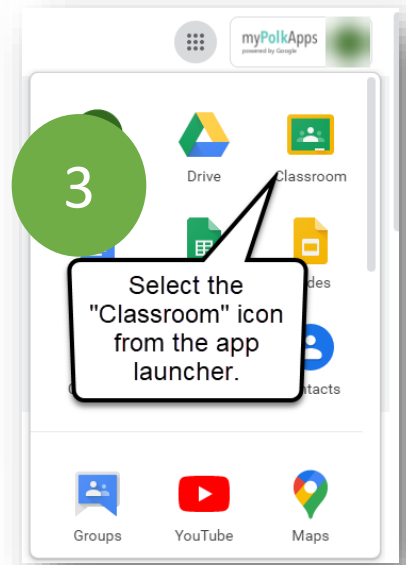

Select the "Classroom" icon from the app launcher.

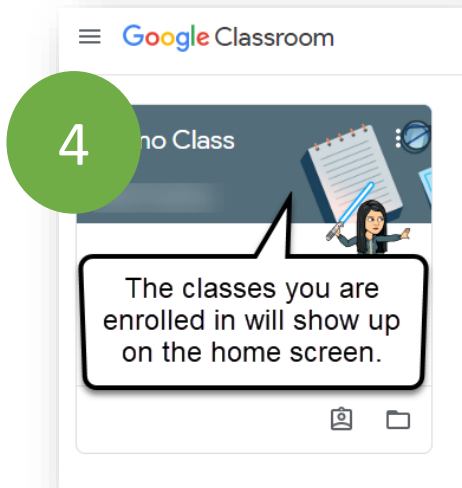

The classes you are enrolled in will show up on the home screen.

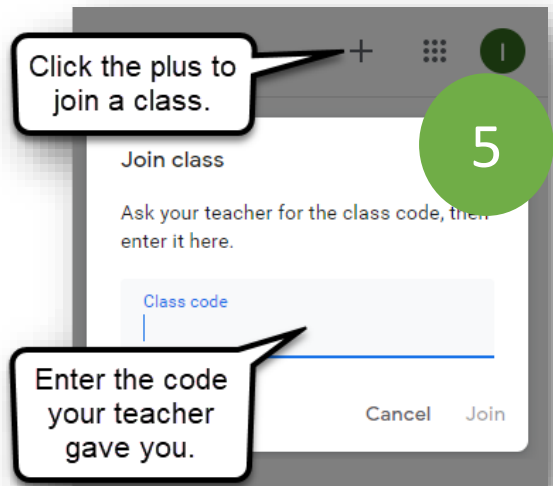

Click the plus to join a class.

Enter the code your teacher gave you.

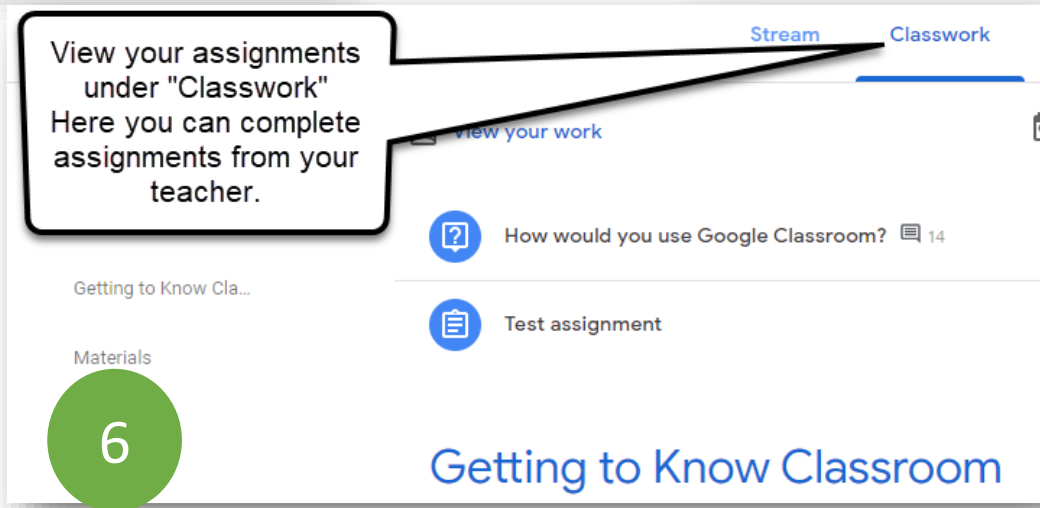

View your assignments under "Classwork" Here you can complete assignments from your teacher.